

総合運動場測量業務委託 用地測量図 S=1:500

壬生町大字壬生甲3828番地

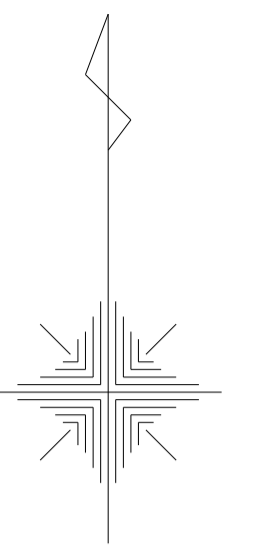

① -A

地番	3841-1	地	現況	雑種地
公簿面積	24970 m ²	目	公簿	山林
所有者名	現況	下都賀郡壬生町		
	公簿	下都賀郡壬生町		
測点	X	Y	距離	
D61105	49153.388	-1647.073	53.544	
D61108	49166.000	-1699.110	11.552	
D61109	49161.874	-1709.900	14.242	
D61098	49149.514	-1716.975	8.712	
D61099	49149.675	-1708.264	8.009	
D61100	49150.080	-1700.265	12.001	
D61101	49151.022	-1688.301	12.032	
D61102	49152.109	-1676.318	10.023	
D61103	49152.873	-1666.324	7.453	
C1065	49153.275	-1658.882	6.584	
D61104	49153.419	-1652.300	5.227	
倍面積	1173	361570		
面積	586	6807850		
地積	586.68	m ²		

(1-B)

D61107	49128.501	-1543.525	50.242
D61106	49140.138	-1592.401	56.255
D61105	49153.388	-1647.073	5.227
D61104	49153.419	-1652.300	6.584
C1065	49153.275	-1658.882	7.453
D61103	49152.873	-1666.324	10.023
D61102	49152.109	-1676.318	12.032
D61101	49151.022	-1688.301	12.001
D61100	49150.080	-1700.265	8.009
D61099	49149.675	-1708.264	8.712
D61098	49149.514	-1716.975	13.804
D61097	49137.534	-1723.832	15.435
K109C	49123.112	-1729.331	41.993
KP160	49083.749	-1743.958	33.262
K3B	49052.500	-1755.355	18.346
K20C	49035.305	-1761.751	1.908
ZP1	49034.855	-1759.897	6.434
NO.5L3.000	49040.896	-1757.682	19.999
NO.4L3.000	49059.672	-1750.795	20.001
NO.3L3.000	49078.450	-1743.909	19.999
NO.2L3.000	49097.226	-1737.023	20.001
NO.1L3.000	49116.004	-1730.136	20.830
ZP12	49135.560	-1722.964	3.647
C1069	49135.442	-1719.319	1.309
C1068	49135.415	-1718.010	10.562
P1067	49135.578	-1707.449	10.049
C1066	49136.143	-1697.416	7.036
P1064	49136.691	-1690.401	7.217
C1063	49137.321	-1683.212	1.360
C1062	49137.444	-1681.858	4.524
C1061	49137.846	-1677.352	9.863
P1060	49138.637	-1667.521	9.812
C1059	49139.171	-1657.724	10.191
C1058	49139.305	-1647.534	9.097
C1057	49138.863	-1638.448	7.887
P1056	49138.011	-1630.607	0.890
C1055	49137.870	-1629.728	10.323
C1054	49135.694	-1619.637	8.772
P1048	49133.500	-1611.144	10.879
C1047	49130.512	-1600.683	4.313
C1046	49129.316	-1596.539	15.657
C1045	49125.501	-1581.354	23.861
P1044	49119.668	-1558.217	9.332
K1031	49115.921	-1549.670	14.001
倍面積	4394	939217	
面積	2447	4696085	
地積	2447.46	m ²	

(1-C)

C1076	49030.553	-1742.179	76.577
C1077	49012.691	-1667.714	20.550
C1078	49007.885	-1647.735	25.554
C1079	49001.947	-1622.880	12.277
C1080	48999.042	-1610.852	23.500
P1003	48993.483	-1588.119	0.531
K1004	48993.357	-1587.603	6.320
K1005	48999.189	-1585.168	2.473
K1006	49001.505	-1584.301	20.007
K1007	49020.215	-1577.216	19.999
K1013	49038.912	-1570.117	20.006
K1014	49057.617	-1563.021	20.000
K1026	49076.314	-1555.921	7.552
K1027	49083.372	-1553.234	12.458
K1028	49094.867	-1548.432	4.442
K1029	49098.966	-1546.720	8.468
K1030	49107.191	-1544.707	10.042
K1031	49115.921	-1549.670	9.332
P1044	49119.668	-1558.217	23.861
C1045	49125.501	-1581.354	15.657
C1046	49129.316	-1596.539	4.313
C1047	49130.512	-1600.683	10.879
P1048	49133.500	-1611.144	8.772
C1054	49135.694	-1619.637	10.323
C1055	49137.870	-1629.728	0.890
P1056	49138.011	-1630.607	7.887
C1057	49138.863	-1638.448	9.097
C1058	49139.305	-1647.534	10.191
C1059	49139.171	-1657.724	9.812
P1060	49138.637	-1667.521	9.863
C1061	49137.846	-1677.352	4.524
C1062	49137.444	-1681.858	1.360
C1063	49137.321	-1683.212	7.217
P1064	49136.691	-1690.401	7.036
C1066	49136.143	-1697.416	10.049
P1067	49135.578	-1707.449	10.562
C1068	49135.415	-1718.010	1.309
C1069	49135.442	-1719.319	3.647
ZP12	49135.560	-1722.964	20.830
NO.1L3.000	49116.004	-1730.136	20.001
NO.2L3.000	49097.226	-1737.023	19.999
NO.3L3.000	49078.450	-1743.909	20.001
NO.4L3.000	49059.672	-1750.795	19.999
NO.5L3.000	49040.896	-1757.682	6.434
ZP1	49034.855	-1759.897	18.233
倍面積	44394	701676	
面積	22197	3508380	
地積	22197.35	m ²	

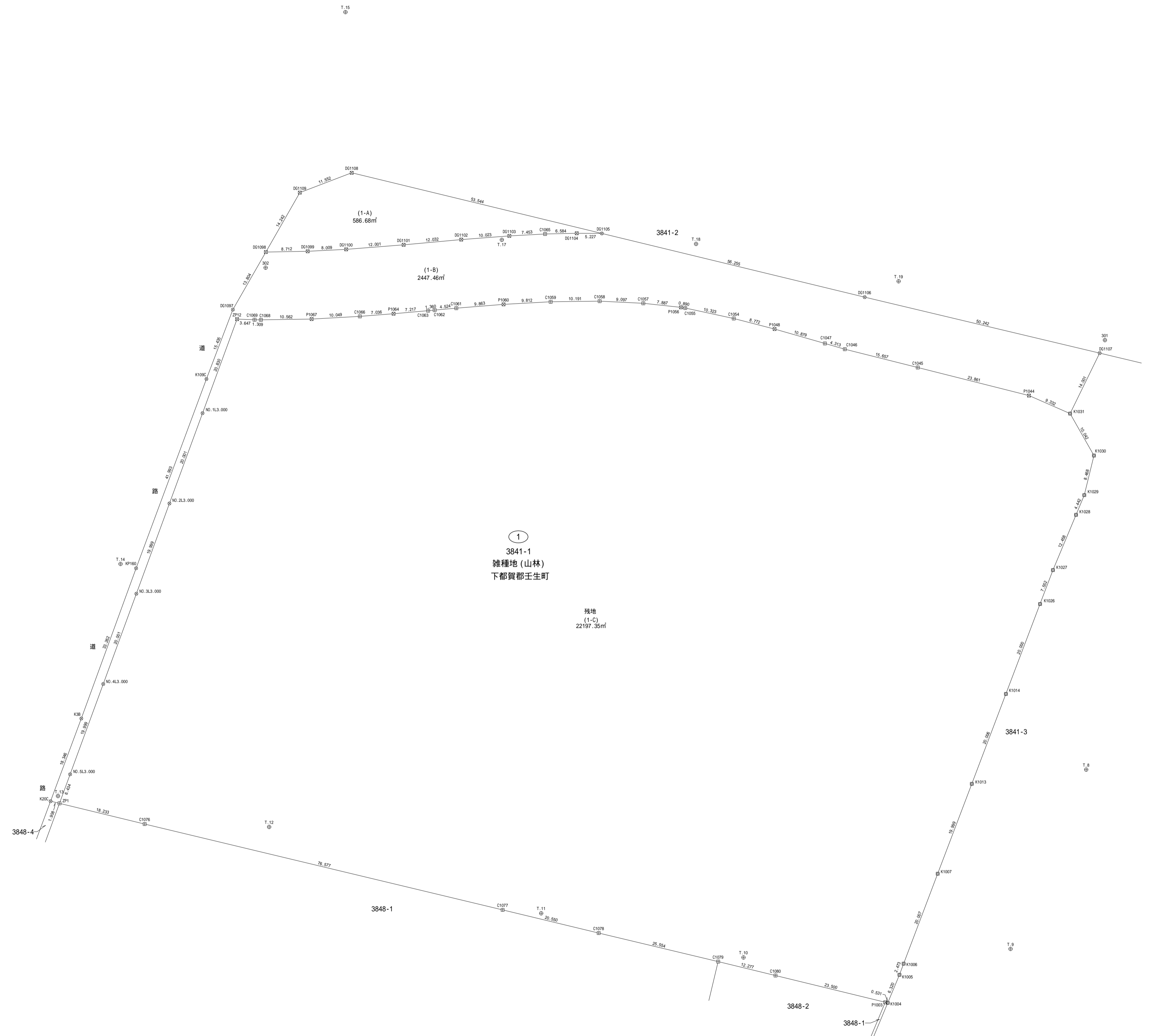

記号	境界標の種類
⊕	基準点
⊙	中心点
○	用地幅
⊠	コンクリート杭
⊞	プラスチック杭
⊠	石杭
⊞	金属標
⊞	金属板
△	うつつ木
●	現況点

工事名	総合運動場測量業務委託 壬生町大字壬生甲3828番地		
図面名	用地測量図		
縮尺	1/500	図面番号	/
会社名	株式会社 栃木県用地補償コンサルタント		